

40^{mm} (1½") – 200^{mm} (8")

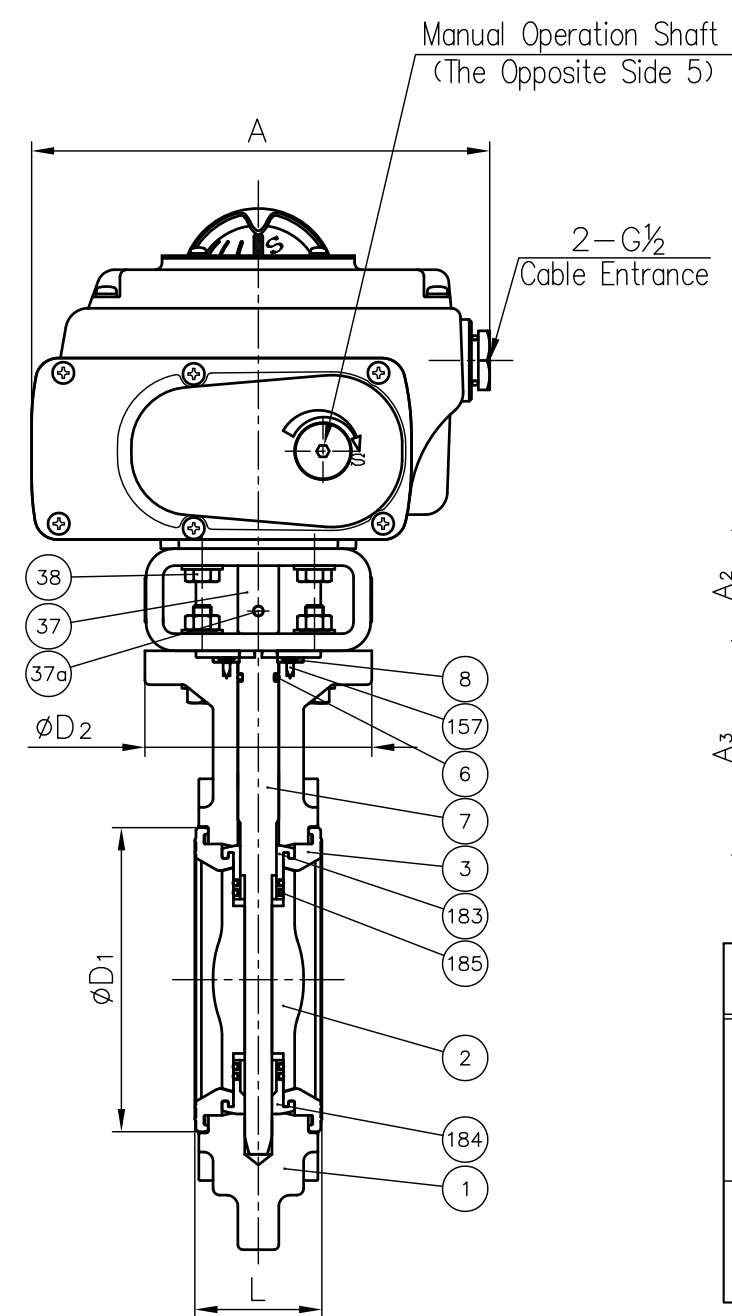

Manual Operation

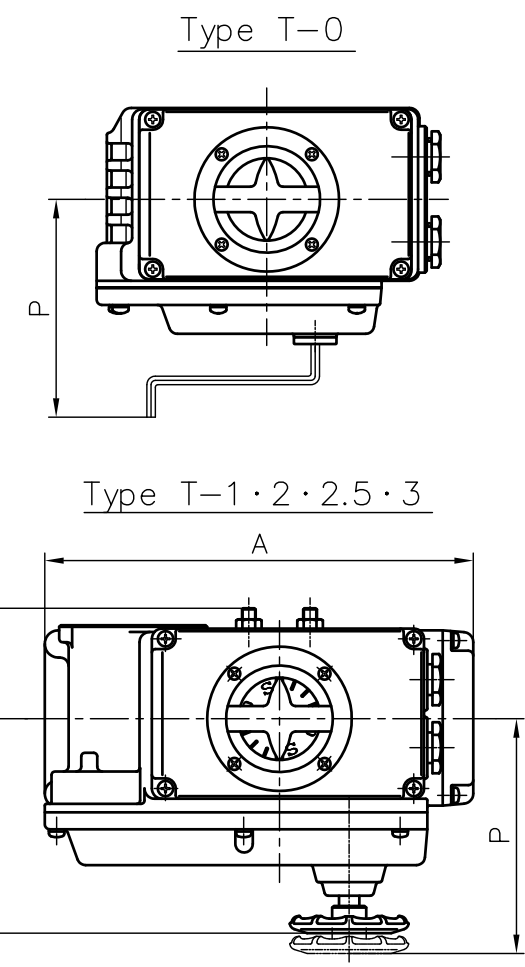

The shape of Stand

250^{mm} (10") – 350^{mm} (14")

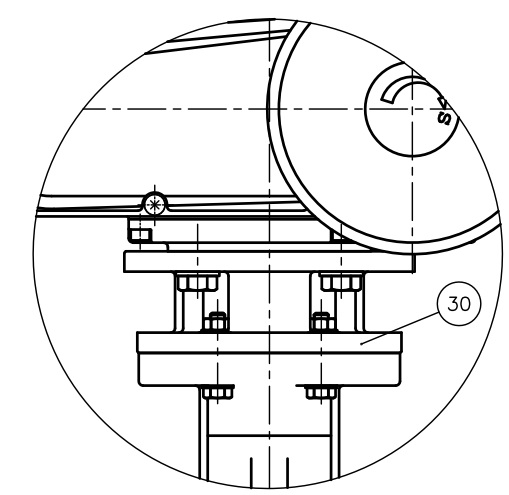

NOTE.

1. The shape and appearance of assembly differ a little with nominal size compared to this drawing.
2. An Actuator Type T-0 has manual operating wrench, another types have manual operating wheel.
3. P shows manual operating position.

Actuator Type	Spec.
T-0	<input type="checkbox"/> Standard
T-1	<input type="checkbox"/> with Potentiometer
T-2	<input type="checkbox"/> with Intermediate Limit Switch
T-2.5	<input type="checkbox"/> with Speed Controller
T-3	<input type="checkbox"/> Standard <input type="checkbox"/> with Potentiometer <input type="checkbox"/> with Intermediate Limit Switch

157	SCREW (F)	4	STAINLESS STEEL (SUS304)	
39	BOLT·NUT (A)	4sets	STAINLESS STEEL (SUS304)	
38	BOLT (E)	4	STAINLESS STEEL (SUS304)	
37a	SCREW (C)	1	STAINLESS STEEL (SUS304)	
37	JOINT (A)	1	COPPER ALLOY (C3604)	
35	ACTUATOR	1	ALUMINUM ALLOYS DIE CASTINGS (ADC12) etc.	
30	STAND	1	PPG CAST ALUMINUM ALLOY (AC4C)	Used for Size 40 ^{mm} –200 ^{mm} Used for Size 250 ^{mm} –350 ^{mm}
8	STEM HOLDER (A)	1	PP	
7	STEM	1	<input type="checkbox"/> STAINLESS STEEL (SUS403) <input type="checkbox"/> STAINLESS STEEL (SUS316)	
185	O-RING (I)	4	<input type="checkbox"/> EPDM	
6	O-RING (C)	1	<input type="checkbox"/> FKM	
3	SEAT	1	<input type="checkbox"/> Others	
2	DISC	1	<input type="checkbox"/> PP / PP	
1	BODY	1	<input type="checkbox"/> PVDF / PVDF	
No.	DESCRIPTION	QTY.	MATERIAL	REMARKS

DIMENSIONS TABLE

Unit : mm

Nominal Size	d	DIN PN10				L	D	D ₁	D ₂	H	H ₁	A	A ₂	A ₃	S	S ₁	S ₂	P	Actuator Type
		C	n	h															
40 ^{mm} 1½"	45	110	4	18	39	150	71	100	290	75	202	53.8	85	117.5	32	7	128	T-0	
50	56	125	4	18	42	165	81	100	300	83	202	53.8	85	127.5	32	7	128	T-0	
65	69	145	4	18	46	185	95	100	310	93	202	53.8	85	137.5	32	7	128	T-0	
80	77	160	4	18	46	211	105	100	325	106	202	53.8	85	152.5	32	7	128	T-0	
100	102	180	8	18	56	238	134	100	340	119	202	53.8	85	167.5	32	7	128	T-0	
125	129	210	8	18	66	255	169	140	376	128	252	65	126	185.5	42	9	138	T-1	
150	150	240	8	22	71	285	190	140	424	143	310	85	154	200.5	42	9	168	T-2	
200	195	295	8	22	87	350	242	140	458	175	310	85	154	231.5	42	9	168	T-2.5	
250	250	350	12	22	112	421	302	180	541	211	388	136	245.5	—	—	—	268	T-3	
300	303	400	12	22	129	488	360	235	598	244	388	136	245.5	—	—	—	268	T-3	
350	351	460	16	22	129	539	393	235	625	270	388	136	245.5	—	—	—	268	T-3	

ITEM	BUTTERFLY VALVE (TYPE 57) ELECTRIC MODEL T TYPE ASS'Y DIN PN10 40 ^{mm} (1½") ~ 350 ^{mm} (14")		
DRAWN	K.Sakiyama	DATE	SCALE
CHECKED	H.Kawano	NOV.30.2014	~
APPROVED	T.Iwamoto	DRAWING No.	
SPECIAL ORDER No.	57-AE001DE		△
ASAHI YUKIZAI CORPORATION			